



## 200 DGR

**ΔP Range:** 0 to 0 to 0.25 upto 7 bar  
0 to 5 upto 100 psi

### COMBINATIONS

#### Gauge



#### Switch

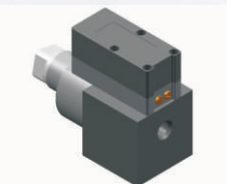

#### Gauge + switch

(with a terminal strip inside)



#### Gauge + switch

(with a DIN plug on top)



### MOUNTING BRACKETS

#### Surface mounting



#### Horizontal pipe mounting



#### Vertical pipe mounting



#### Panel / Flange mounting

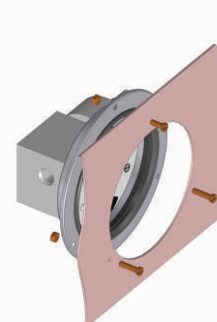

### Specifications

Accuracy	±2% of the FSD (Ascending)
Migration	No migration. Zero leakage from high to low port
Range	0-0.25 to 0-7 bar or equivalent ranges in other units
First marking on the scale	15% of the FSD
Sensing element	Diaphragm
Wetted parts	Diaphragm, body material, SS 302 spring & ceramic magnet
Case material & dial size	Stainless steel (SS 304): 2.5", 3.5", 4", 4.5", 6" Engineering polymer: 2.5", 4.5", 6" Bayonet: 4"
Mounting	Direct, front flange, 2" pipe & surface mounting
Maximum working pressure	200 bar / 3000 psi
Maximum process temperature	0 to 80°C (32 to 175°F)
Body material	Aluminum, Brass, SS 316, Monel
Diaphragm	Buna-N, Viton, EPDM
Window	Float glass (Std.), toughened glass, acrylic & safety glass
Connection	1/4" NPT(F) (Std.), 1/4" BSP(F) and others through adaptor
Porting	In-line, rear, bottom, in-line & bottom.
Over range protection	Up to the max. working pressure from high side. <i>Never pressurize only LP side beyond 25 bar</i>
Protection for gauge & switch	IP 65 / NEMA-4

### Options

Liquid filling (glycerine/ silicone)
Red follower pointer
Customer logo
Dual scale
Color band
Filter mesh in (+) connection
Descending calibration

### Switches (Adjustable in 30-100% of FSD)

1 or 2 SPSTs with a DIN plug
1 or 2 SPSTs with a terminal strip
1 SPST with a built in relay
1 or 2 SPDTs with a terminal strip
1 or 2 SPDTs with a DIN plug

### Available in engineering polymer (EP) Case



6.0"



4.5"



2.5"

- Removable glass
- Strong and durable
- Panel mounting possible
- Condensation can be cleaned
- Light weight

### SELECT MODEL

1 Series	200 DGR			
2 Type	G	Gauge	S	Switch
	GS	Gauge + Switch		
3 Body material	A	Aluminum	S	SS-316
	B	Brass	M	Monel
4 Dial size	2.5	2.5" (63 mm)	4.5	4.5" (115 mm)
	3.5	3.5" (80 mm)	6.0	6.0" (150 mm)
	4.0	4.0" (100 mm)		
5 Connection	4N	1/4" NPT (F) (Std.)	4B	1/4" BSP (F)
	ZZ	Special connection sizes using adaptor		
6 Porting	1	In-line (Std.)	4	Inline & bottom
	2	Rear / Back		
	3	Bottom		
7 Case	S4	SS 304 (Std.)	S6	SS 316
	F4	SS 304 flange		
	EP	Engineering polymer (available in 2.5", 4.5", 6.0" only)		
	BF	Bayonet (available in 4.0" safety glass only)		
8 Window	F	Glass (Std.)	A	Acrylic
	T	Toughened glass	L	Safety glass
9 Seals/Diaphragm	B	Buna-N (Std.)	E	EPDM
	V	Viton		
10 Switch	Select option & specifications			

#### Advantages :

Instrument automatically resets after line surges and cold start.  
This eliminates balancing of differential pressure instrument after such events.

#### Notes

- Top vent not available.
- For SS 316 case, please contact factory (MOQ applies).
- Liquid filling + Follower pointer available.
- Switch adjustment range between 30-100% of full scale deflection (FSD). For specific details, please contact factory.
- Mounting bracket: Aluminum (Standard) ; SS (Optional)

0	None
1	One SPST, with a DIN plug †
2	One SPST, with a terminal strip
2A	One SPST, with built in relay
3	Two SPSTs, with a DIN plug †
4	Two SPSTs, with a terminal strip

+

#### SPST Specifications (AC/DC max)

1 Standard	2	3	4
10 VA	40 VA	100 VA	60 VA
100 V	230 V	300 V	240 V
0.5 Amp	1 Amp	1 Amp	3 Amp
Adjustable	Adjustable	Adjustable	Adjustable

5	One SPDT, with a DIN plug †
6	One SPDT, with a terminal strip
7	Two SPDTs, with two DIN plugs
8	Two SPDTs, with a terminal strip

+

#### SPDT Specifications (AC/DC max)

1 Standard	2	3
3 VA	5 VA	5 VA
30 V	125 V	175 V
0.3 Amp	0.25 Amp	0.25 Amp
Adjustable	Adjustable	Adjustable

Example: Switch selection 21 is 1 SPST with terminal strip  
with switch specifications 10VA, 100V, 0.5Amp

† DIN plug mounted on the top.

### 11 Range

#### Standard ranges : (Other ranges & units on request)

Kg/cm <sup>2</sup>	0.25	-	0.5	0.75	1	-	2	2.5	-	4	7
bar	0.25	-	0.5	0.75	1	-	2	2.5	-	4	7
mbar	250	-	-	750	-	-	-	-	-	-	-
psi	-	5	7	-	15	25	30	-	40	60	100
kPa	25	-	50	75	100	-	200	250	-	400	700

### 12 Options

0	None
A	Glycerine*
B	Red follower pointer on acrylic window *
C	Customer Logo
D	Dual scale
E	Colour band
F	Filter mesh in (+) connection
H	Descending calibration (long delivery time)
N	NACE
S	Silicone oil*
I	Oxygen service (Contact factory)
M1	2" horizontal pipe mounting bracket
M2	Surface mounting bracket
M3	2" vertical pipe mounting bracket

\* Affects accuracy

### Ordering code sequence

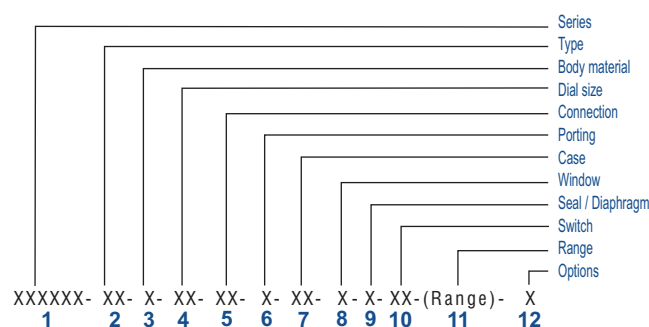

Contact factory for special execution.